

*

3507

BOARD DIPLOMA EXAMINATION, (C-09)
MARCH/APRIL-2019
DME - FOURTH SEMESTER EXAMINATION
PRODUCTION DRAWING

Time: 3Hours]

[Max.Marks: 60

PART-A**4x5=20M**

Instructions: Answer all the questions and each question carries five marks.

- 1) Calculate the values of min.and max. allowances, hole tolerance, shaft tolerance and indicate type of fit for assmbely with a basic size of 50mm and tolerance indicated as H_7/g_6 .
- 2) Sketch the symbols for tolerance of from and position for the follwing
 - a) Angularity b) Symmetry c) Cylindritic d) Flatness e) Perpendicularity.
- 3) Mention the average roughness values that can be obtained from the follwing process.
 - a) Forging b) Shaping c) Drilling d)Hot rolling e) Broaching
- 4) Explain the followinf designation
 - a) HEX BOLT M20 X 75NL
 - b) Stud B M20X60
 - c) Cylindrical pin 10 h_8 x20
 - d) Taper key 12x8x50
 - e) Ball Bearing 305

*

WWW.MANARESULTS.CO.IN

PART-B

1x40=40M

Instructions: 1) Answer any one of the following question.

2) Choose suitable scale.

5) Student the given assembly drawing of Drill Jig.

a) Draw the Component drawings for 1,2,3,7 parts

b) Indicate the surface roughness values on 1,2,3,7 parts

c) Indicate geometrical tolerances wherever needed for 1,2,3,7 parts.

d) Dimensional tolerances & Mention type of fits between mating parts 1-2&2-3.

e) Prepare the process sheet for drill bush.

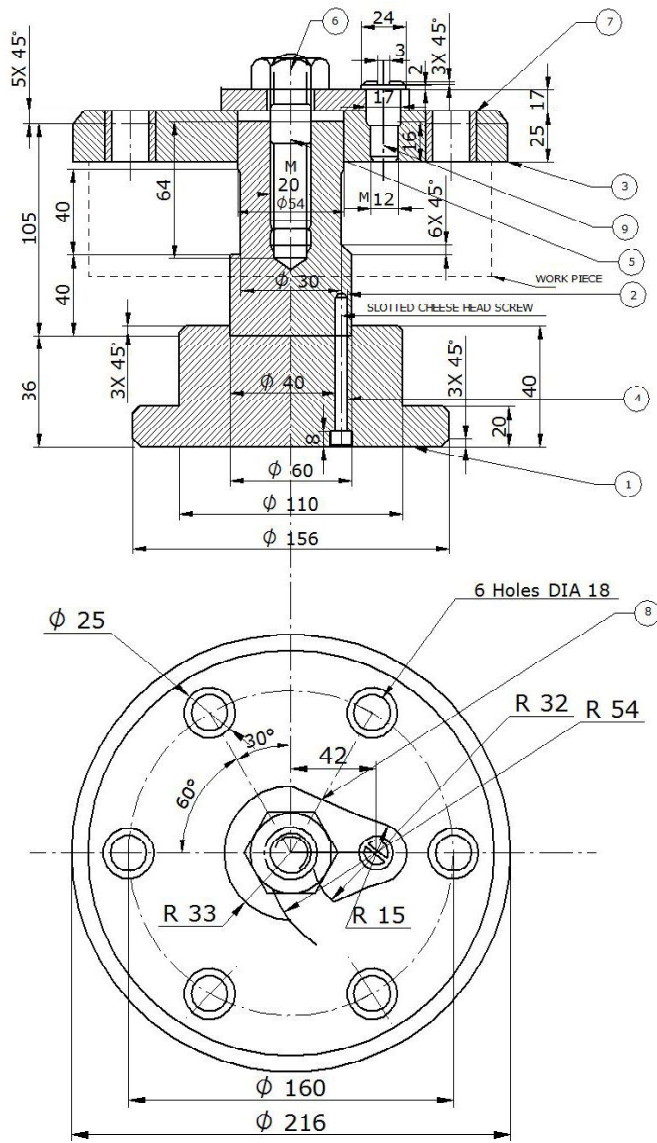

Bill of Material

Part No.	Name	Raw Material	Qty
1	Base plate	C.I - casting	01
2	Stem	MS-φ63 Barstock	01
3	Jig plate	CI-casting	01
4	Screw	MS-std.component	03
5	Stud	MS-std.component	01
6	Nut	MS-std.component	01
7	Bush	MCS-φ32 bar stock	06
8	Latch washer	MS-stamping	01
9	Screw	MS-φ25 Bar stock	01

WWW.MANARESULTS.CO.IN

- 6) Study the given assembly drawing of screw jack shown in fig 2
- Draw the component drawings or all the parts.
 - Apply suitable fits and tolerances
 - Apply Suitable geometrical tolerances.
 - Indicate surface roughness values on all parts.
 - Prepare the process sheet for "screw"

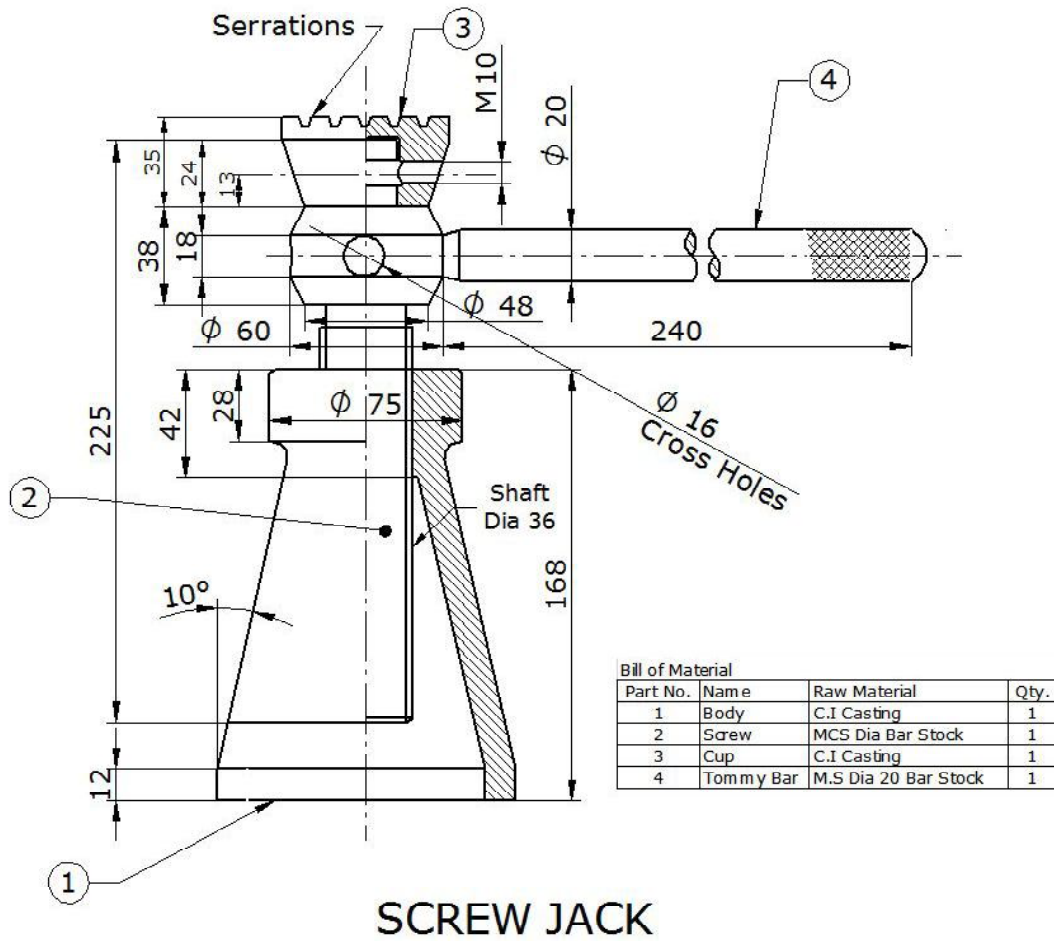

* * *